

LEGEND	
	EXISTING PAVEMENT MARKINGS TO REMAIN
	EXISTING PAVEMENT MARKINGS REMOVED
	NEW PAVEMENT MARKINGS
	CYCLE DIVIDER
	HIT POSTS - WHITE
	HIT POST - BLACK
	SPEED HUMP
	CYCLEWAY MARKING
	SHARROW MARKING

300 mm
200
100
50
0 10 mm

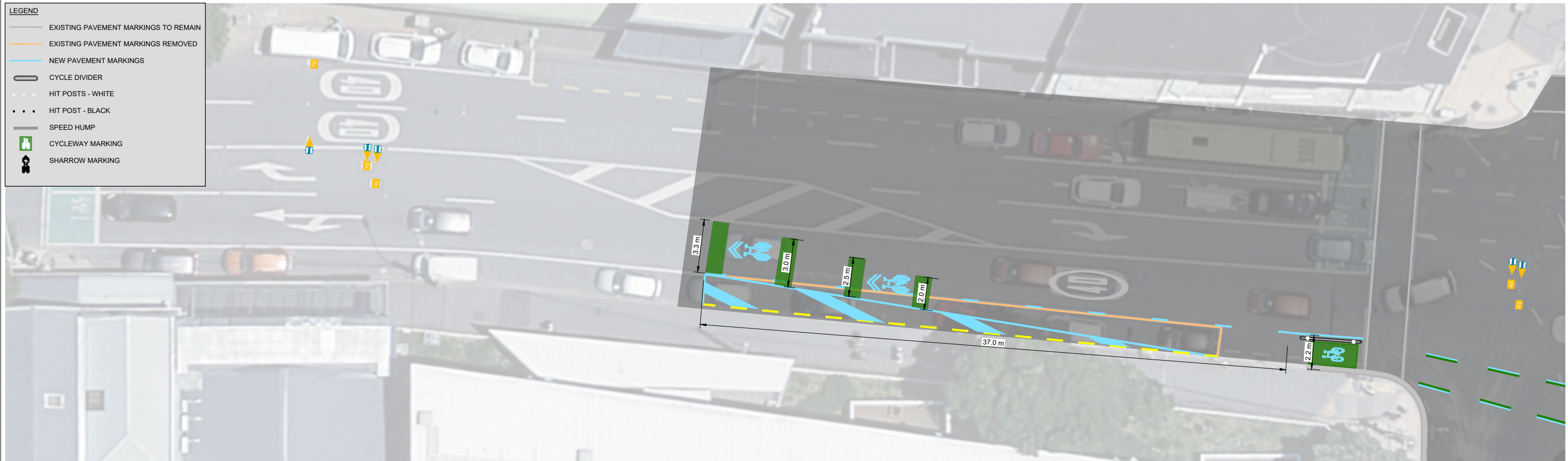

RIDDIFORD STREET - PART 1

1:125 @ A1
1:250 @ A3

REVISION	AMENDMENT	APPROVED	DATE
1	FOR CONSTRUCTION	C.G.	2022-08-09



CIVIL - URBAN DESIGN

SCALES		ORIGINAL SIZE
1:125 (A1), 1:250 (A3)		A1
DRAWN	DESIGNED	APPROVED
C. GROOM	C. GROOM	C. GROOM
DRAWING VERIFIED	DESIGN VERIFIED	APPROVED DATE
C. GROOM	S. THORNTON	2022-08-09

DRAFT FOR COMMENT

PROJECT		SHEET NO.	REVISION
WELLINGTON CITY COUNCIL NEWTOWN TO WATERFRONT CYCLEWAY POST CONSTRUCTION		C210	1
TITLE			
RIDDIFORD STREET LANE MARKING PLAN - SHEET 1 OF 2			
WSP PROJECT NO. (SUB-PROJECT)			
5-C4623.00(5)			



RIDDIFORD STREET - PART 2



RIDDIFORD STREET - PART 3

1:125@A1
1:250@A3

REVISION	AMENDMENT	APPROVED	DATE
1	FOR CONSTRUCTION	C.G.	2022-08-09



CIVIL - URBAN DESIGN

SCALES		ORIGINAL SIZE
1:125 (A1), 1:250 (A3)		A1
DRAWN	DESIGNED	APPROVED
C. GROOM	C. GROOM	C. GROOM
DRAWING VERIFIED	DESIGN VERIFIED	APPROVED DATE
C. GROOM	S. THORNTON	2022-08-04

DRAFT FOR COMMENT

PROJECT		SHEET NO.	REVISION
WELLINGTON CITY COUNCIL NEWTOWN TO WATERFRONT CYCLEWAY POST CONSTRUCTION		C212	1
TITLE		RIDDIFORD STREET LANE MARKING PLAN - SHEET 2 OF 2	
WSP PROJECT NO. (SUB-PROJECT)		5-C4623.00(5)	

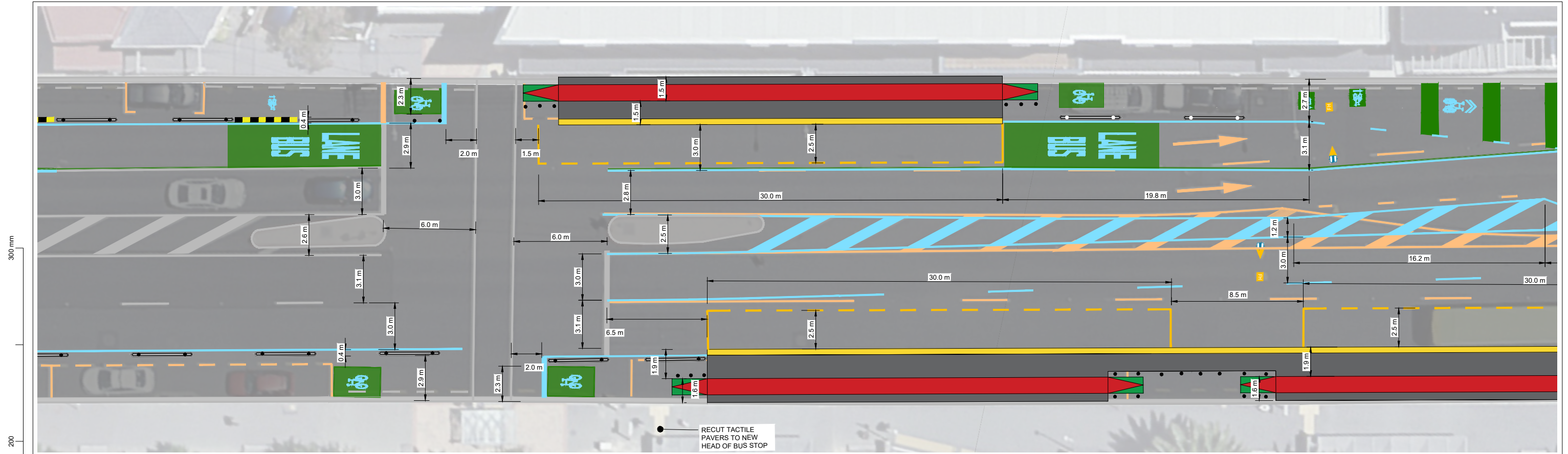

RIDDIFORD STREET - PART 3

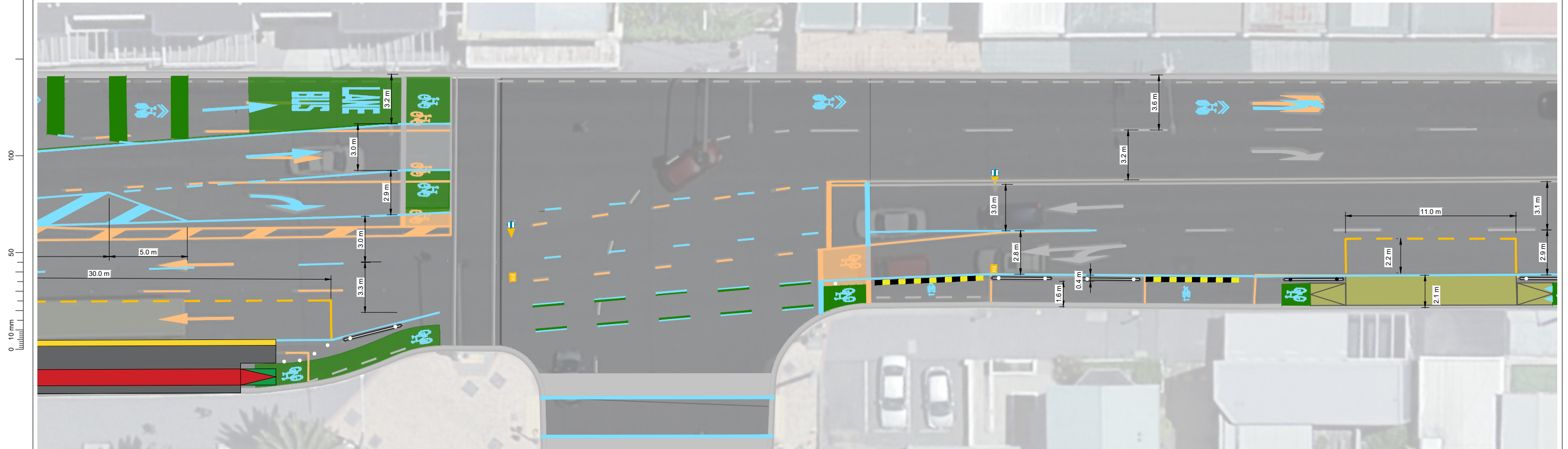

RIDDIFORD STREET - PART 4

1:125@ A1
1:250@ A3

REVISION	AMENDMENT	APPROVED	DATE
1	ISSUED FOR CONSTRUCTION	CG	2022-04-13



CIVIL - URBAN DESIGN

SCALES	DESIGNED	APPROVED
1:125 (A1), 1:250 (A3)	U. GABRIEL	C. GROOM
DRAWN	DRAWING VERIFIED	APPROVED DATE
P. MANI	S. THORNTON	2022-04-13

FOR CONSTRUCTION

PROJECT	TITLE	WSP PROJECT NO. (SUB-PROJECT)	SHEET NO.	REVISION
WELLINGTON CITY COUNCIL NEWTOWN TO WATERFRONT CYCLEWAY	RIDDIFORD STREET - HALL STREET TO ADELAIDE ROAD LANE MARKINGS PLAN - SHEET 2 OF 3	5-C4623.00(1)	C212	1

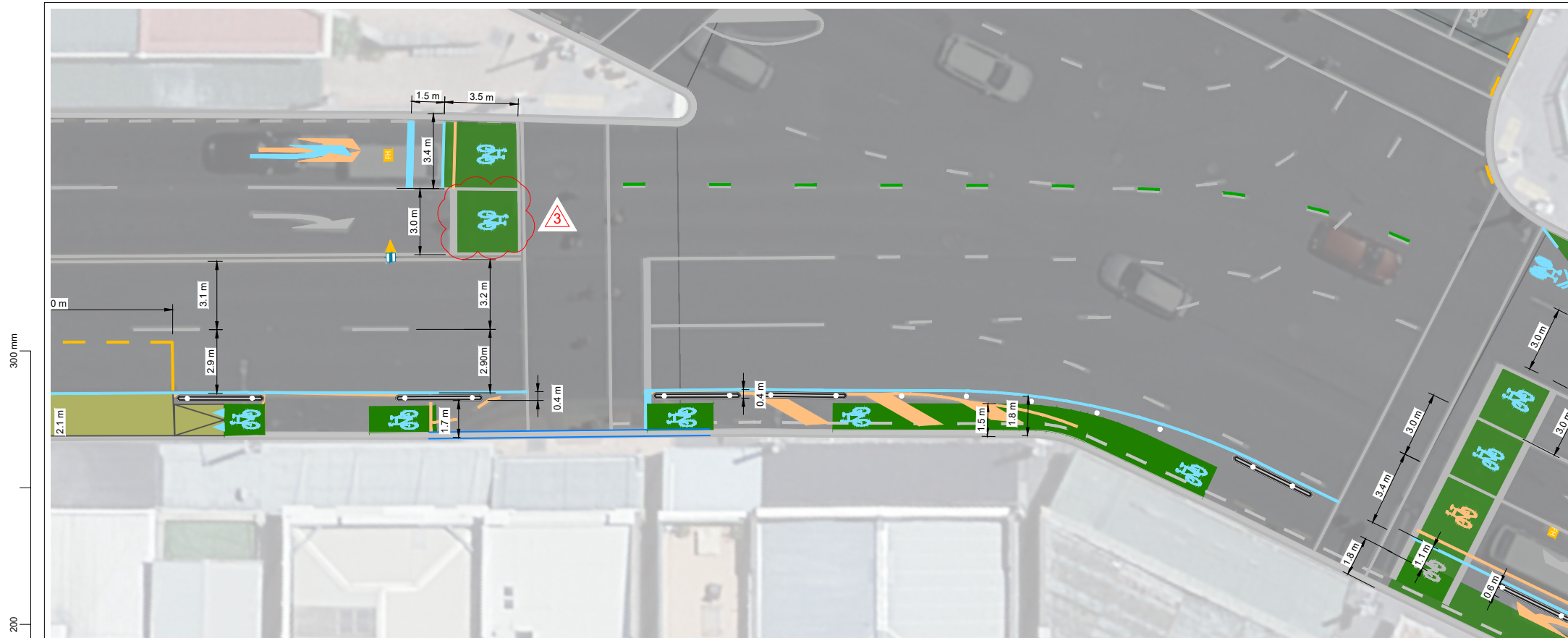

RIDDIFORD STREET - PART 5

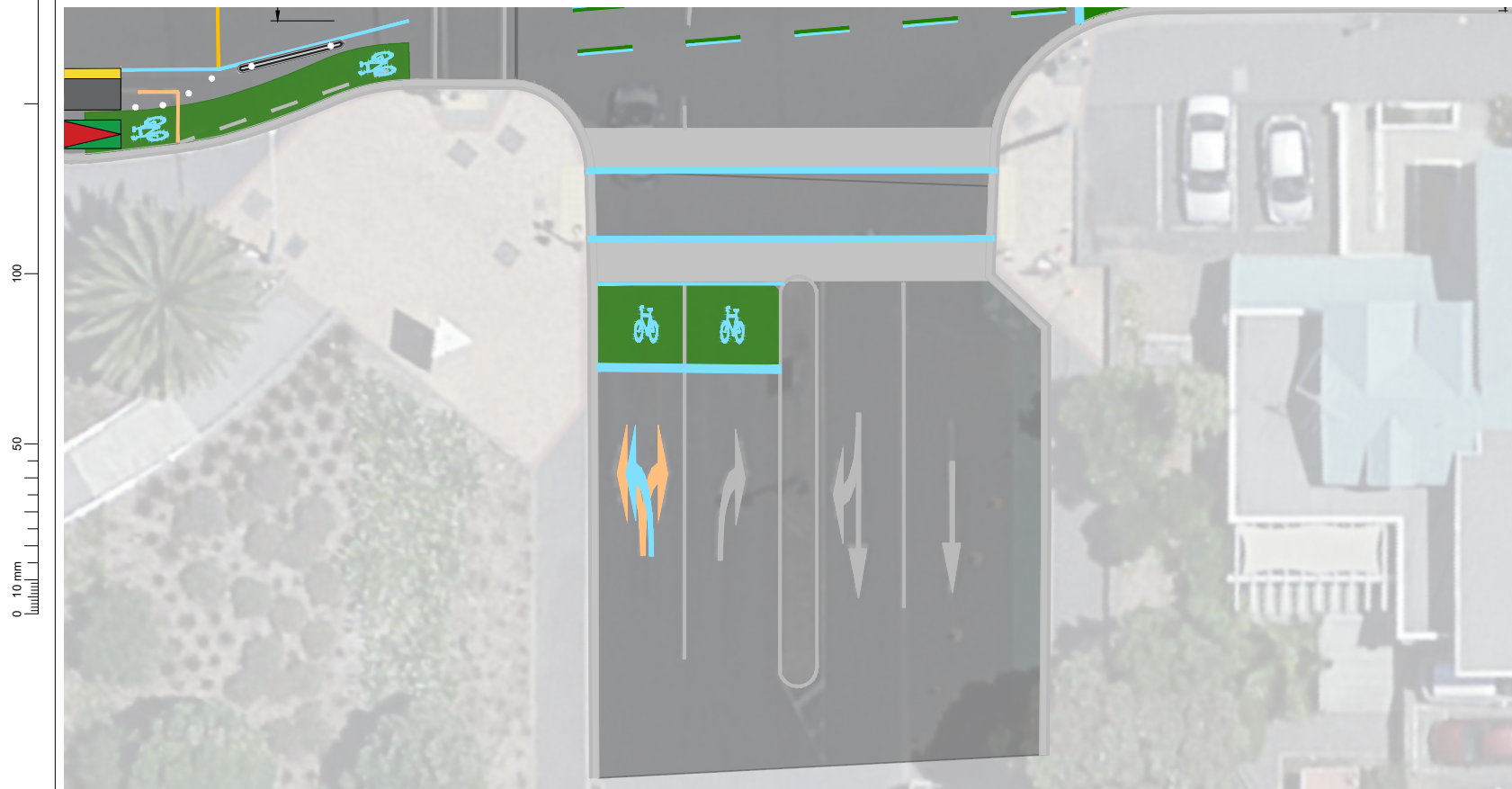

HOSPITAL ACCESS ROAD - PART 1

1:125@ A1
1:250@ A3

REVISION	AMENDMENT	APPROVED	DATE
1	ISSUED FOR CONSTRUCTION	CG	2022-04-13
2	TURNING LINE	CG	2022-05-02
3	ADVANCE STOP BOX	CG	2022-05-12



CIVIL - URBAN DESIGN

SCALES	DESIGNED	APPROVED	ORIGINAL SIZE
1:125 (A1), 1:250 (A3)	U. GABRIEL	C. GROOM	A1
DRAWN	DESIGN VERIFIED	APPROVED DATE	
P. MANI	S. THORNTON	2022-04-13	

FOR CONSTRUCTION

PROJECT	TITLE	WSP PROJECT NO. (SUB-PROJECT)	SHEET NO.	REVISION
WELLINGTON CITY COUNCIL NEWTOWN TO WATERFRONT CYCLEWAY	RIDDIFORD STREET - HALL STREET TO ADELAIDE ROAD LANE MARKINGS PLAN - SHEET 3 OF 3	5-C4623.00(1)	C213	3

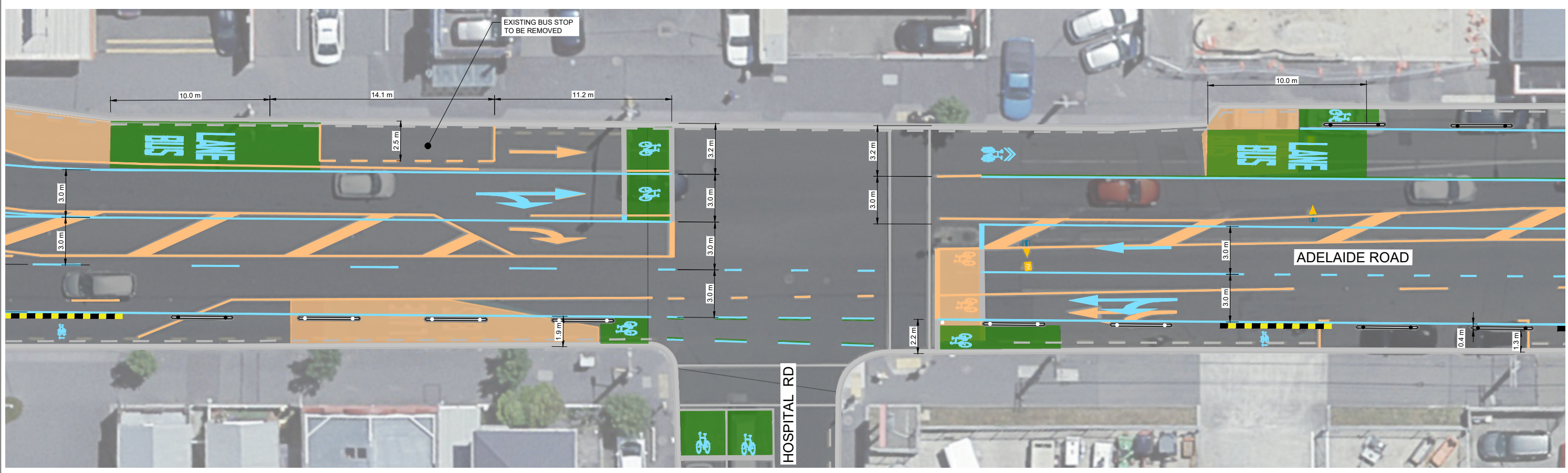
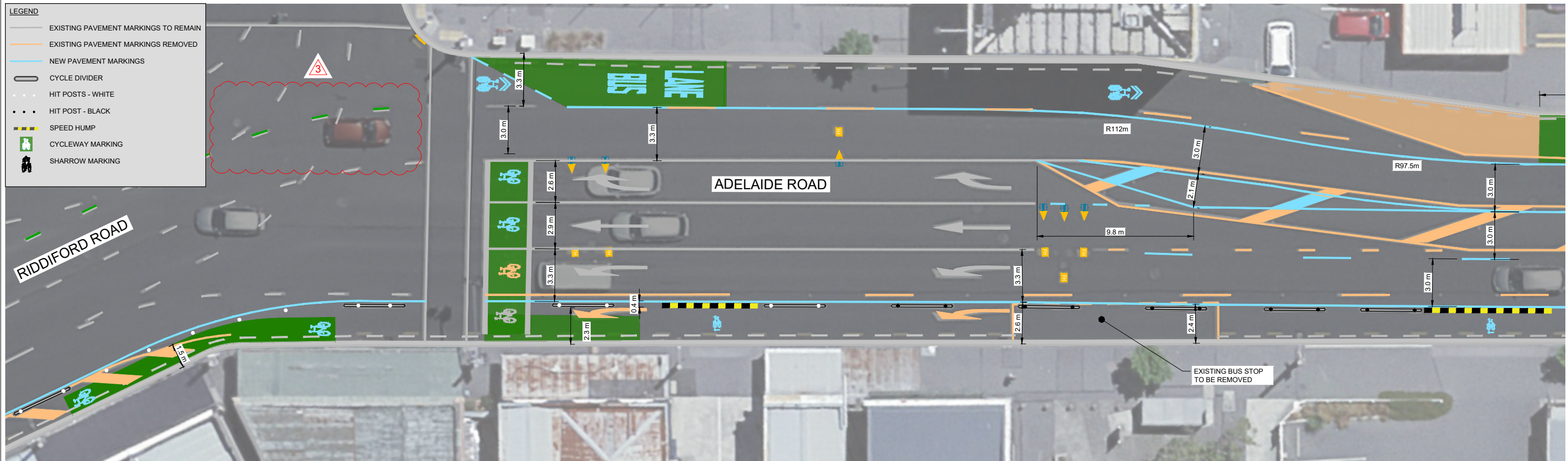

1:125@ A1
1:250@ A3

REVISION	AMENDMENT	APPROVED	DATE
1	ISSUED FOR CONSTRUCTION	CG	2022-04-13
2	AMENDED CONSTRUCTION ISSUE	CG	2022-04-22
3	TURNING LINE	CG	2022-05-02



CIVIL - URBAN DESIGN

SCALES	DESIGNED	APPROVED	ORIGINAL SIZE
1:125 (A1), 1:250 (A3)	U.GABRIEL	C. GROOM	A1
DRAWN	DESIGNED	APPROVED	
P. MANI	U.GABRIEL	C. GROOM	
DRAWING VERIFIED	DESIGN VERIFIED	APPROVED DATE	
B.CRAIG	S. THORNTON	2022-04-13	

FOR CONSTRUCTION

PROJECT	TITLE	WSP PROJECT NO. (SUB-PROJECT)	SHEET NO.	REVISION
WELLINGTON CITY COUNCIL NEWTOWN TO WATERFRONT CYCLEWAY	ADELAIDE ROAD - RIDDIFORD STREET TO BASIN RESERVE LANE MARKING PLAN - SHEET 1 OF 5	5-C4623.00(1)	C214	3

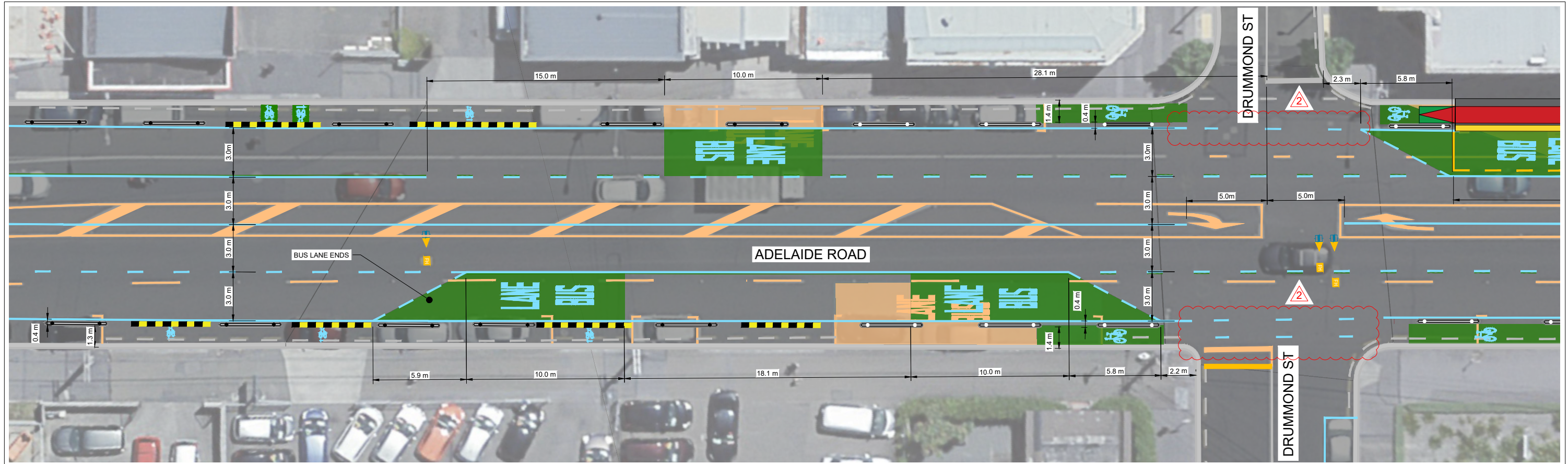

ADELAIDE ROAD - PART 3

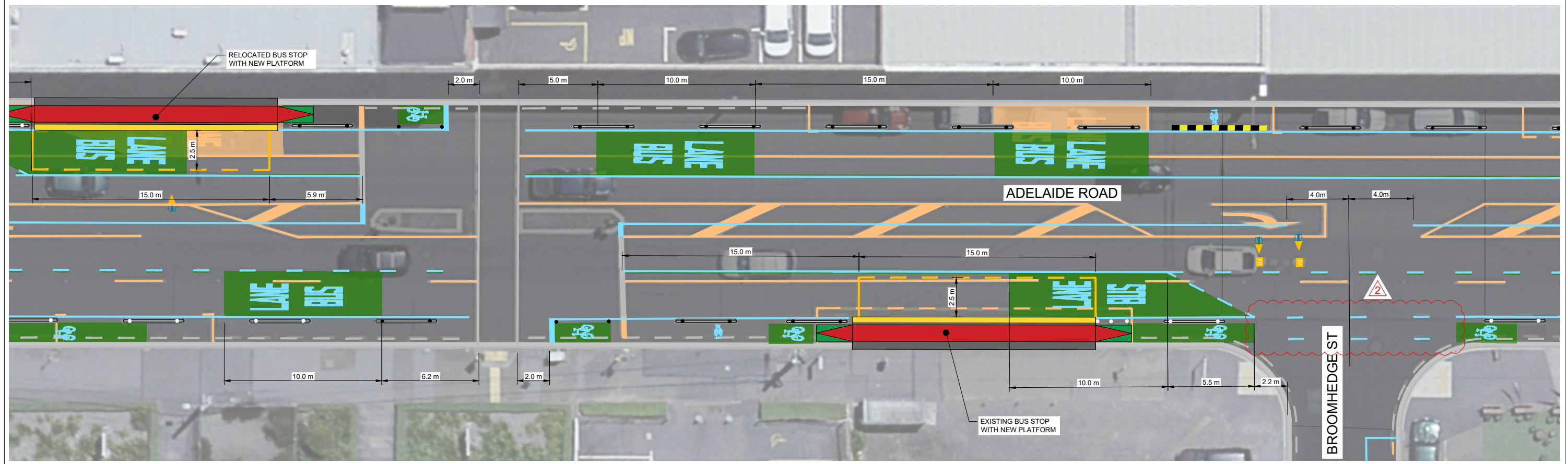

ADELAIDE ROAD - PART 4

1:125@ A1
1:250@ A3

REVISION	AMENDMENT	APPROVED	DATE
1	ISSUED FOR CONSTRUCTION	CG	2022-04-13
2	AMENDED CONSTRUCTION ISSUE	CG	2022-04-22



CIVIL - URBAN DESIGN

SCALES		ORIGINAL SIZE
1:125 (A1), 1:250 (A3)		A1
DRAWN	DESIGNED	APPROVED
P. MANI	U. GABRIEL	C. GROOM
DRAWING VERIFIED	DESIGN VERIFIED	APPROVED DATE
B. CRAIG	S. THORNTON	2022-04-13

FOR CONSTRUCTION

PROJECT		DATE
WELLINGTON CITY COUNCIL NEWTOWN TO WATERFRONT CYCLEWAY		A1
TITLE		
ADELAIDE ROAD - RIDDIFORD STREET TO BASIN RESERVE LANE MARKING PLAN - SHEET 2 OF 5		
WSP PROJECT NO. (SUB-PROJECT)		SHEET NO.
5-C4623.00(1)		C215
		REVISION
		2

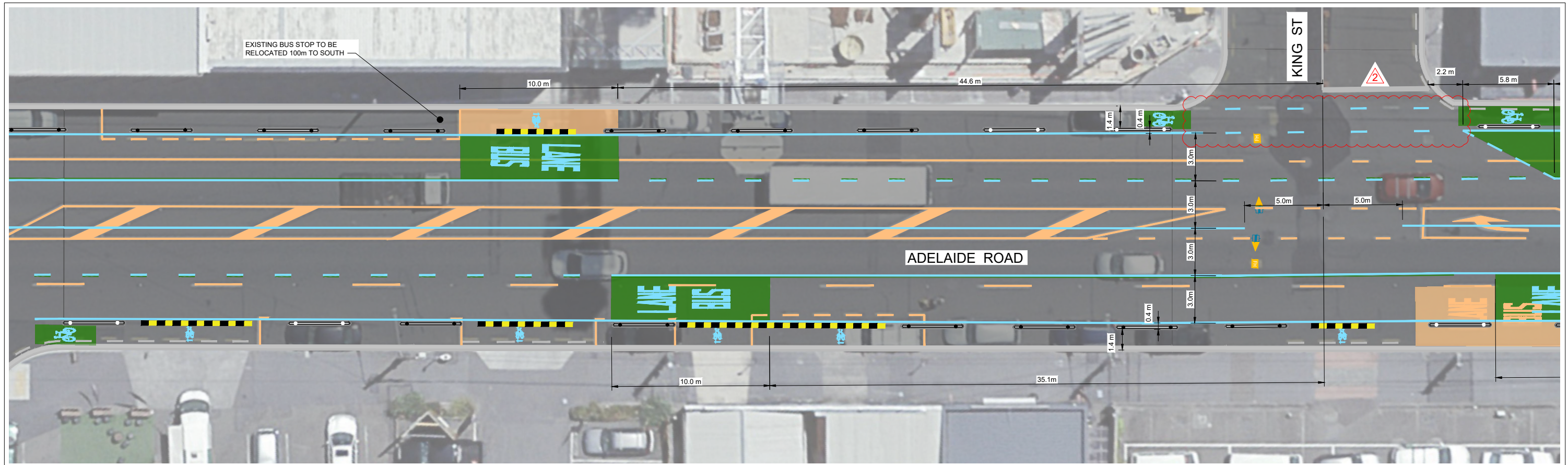

ADELAIDE ROAD - PART 5

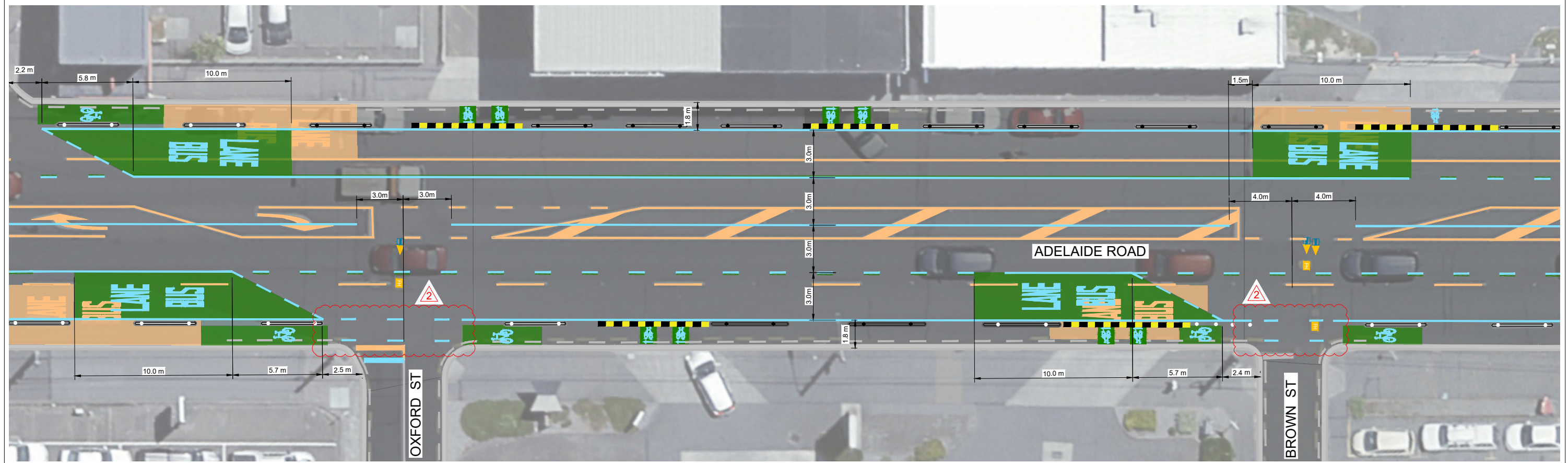

ADELAIDE ROAD - PART 6



REVISION	AMENDMENT	APPROVED	DATE
1	ISSUED FOR CONSTRUCTION	CG	2022-04-13
2	AMENDED CONSTRUCTION ISSUE	CG	2022-04-22



CIVIL - URBAN DESIGN

SCALES		ORIGINAL SIZE
1:125 (A1), 1:250 (A3)		A1
DRAWN	DESIGNED	APPROVED
P. MANI	U. GABRIEL	C. GROOM
DRAWING VERIFIED	DESIGN VERIFIED	APPROVED DATE
B. CRAIG	S. THORNTON	2022-04-13

FOR CONSTRUCTION

PROJECT		
WELLINGTON CITY COUNCIL NEWTOWN TO WATERFRONT CYCLEWAY		
TITLE		
ADELAIDE ROAD - RIDDIFORD STREET TO BASIN RESERVE LANE MARKING PLAN - SHEET 3 OF 5		
WSP PROJECT NO. (SUB-PROJECT)		SHEET NO.
5-C4623.00(1)		C216
		REVISION
		2

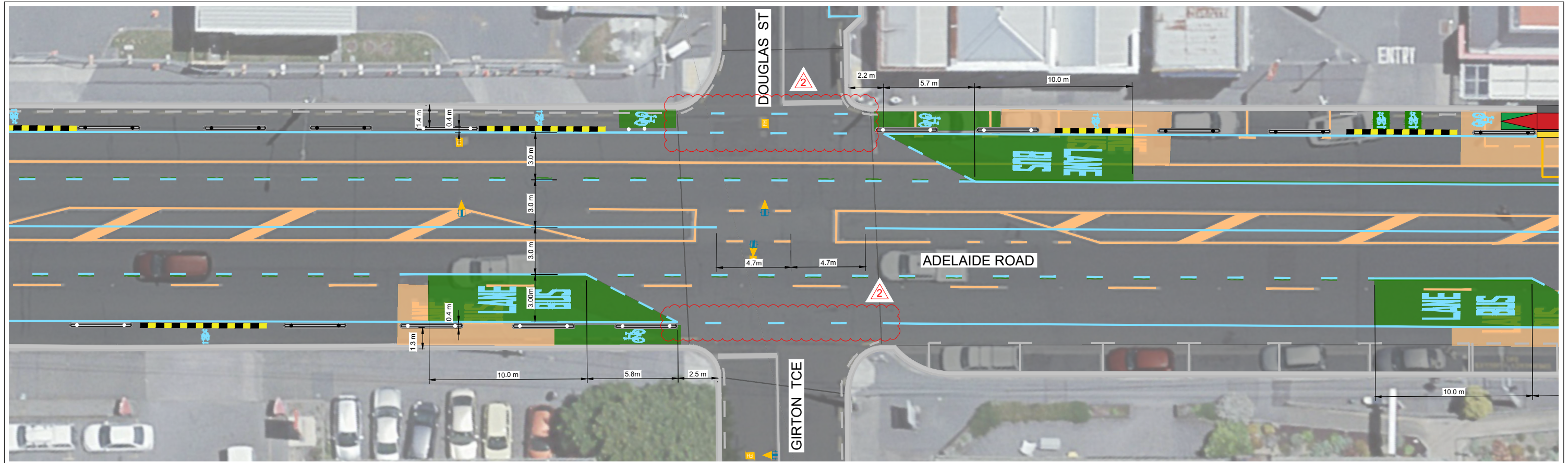

ADELAIDE ROAD - PART 7

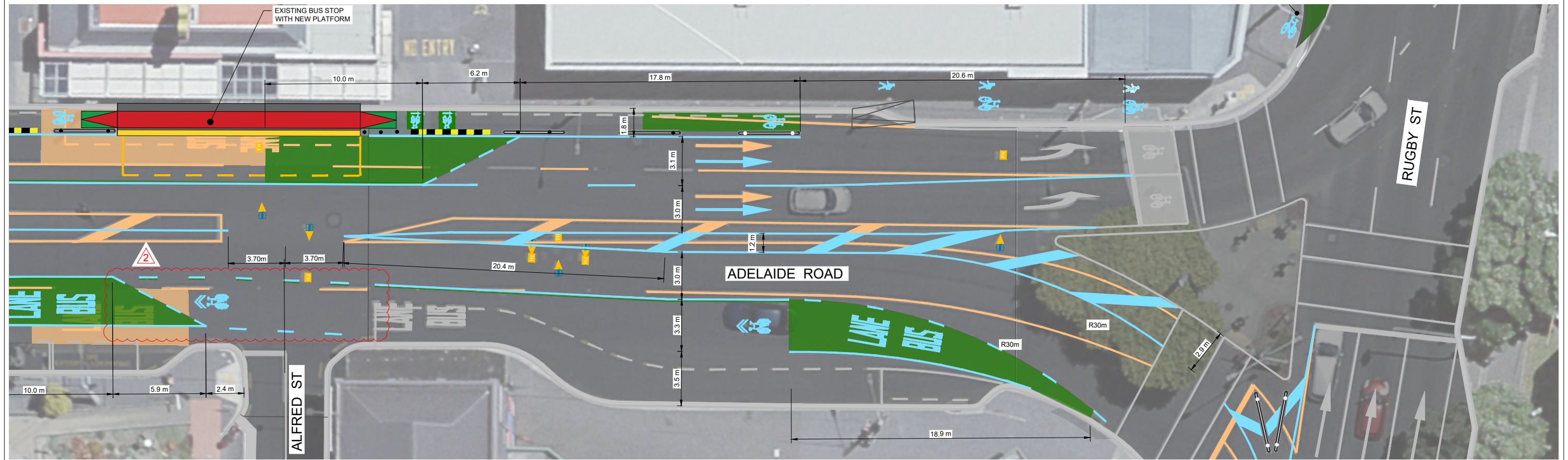

ADELAIDE ROAD - PART 8

1:125 @ A1
1:250 @ A3

REVISION	AMENDMENT	APPROVED	DATE
1	ISSUED FOR CONSTRUCTION	CG	2022-04-13
2	AMENDED CONSTRUCTION ISSUE	CG	2022-04-22



CIVIL - URBAN DESIGN

SCALES		ORIGINAL SIZE
1:125 (A1), 1:250 (A3)		A1
DRAWN	DESIGNED	APPROVED
P. MANI	U. GABRIEL	C. GROOM
DRAWING VERIFIED	DESIGN VERIFIED	APPROVED DATE
B. CRAIG	S. THORNTON	2022-04-13

FOR CONSTRUCTION

PROJECT		SHEET NO.	REVISION
WELLINGTON CITY COUNCIL NEWTOWN TO WATERFRONT CYCLEWAY		C217	2
TITLE		ADELAIDE ROAD - RIDDIFORD STREET TO BASIN RESERVE LANE MARKING PLAN - SHEET 4 OF 5	
WSP PROJECT NO. (SUB-PROJECT)		5-C4623.00(1)	



RUGBY STREET - PART 9

NOTES:

1. THE CONTRACTOR SHALL PRODUCE A DETAILED TRAFFIC MANAGEMENT PLAN THAT COVERS ALL ASPECTS OF CONTROLLING TRAFFIC THROUGHOUT THE DURATION OF THE WORKS.
2. WORKMANSHIP AND MATERIALS GENERALLY SHALL BE IN ACCORDANCE WITH THE RELEVANT NEW ZEALAND STANDARDS, THE N.Z. BUILDING CODE AND MANUFACTURERS WRITTEN RECOMMENDATIONS EXCEPT WHERE VARIED BY THE CONTRACT DOCUMENTS.
3. NOT ALL EXISTING SERVICES AND UTILITIES ARE SHOWN.
4. EXISTING SERVICES, THEIR LOCATIONS AND SIZES SHOWN ON THESE DRAWINGS ARE INDICATIVE ONLY AND ARE BASED ON RECORDS SUPPLIED BY THE UTILITY COMPANIES. PRIVATE SERVICES AND CONNECTIONS ARE NOT SHOWN.
5. THIS 2D DESIGN IS INDICATIVE ONLY AND HAS BEEN DRAWN WITHOUT THE USE OF A TOPOGRAPHIC SURVEY.
6. ALL PAVEMENT MARKINGS ARE TO BE IN ACCORDANCE WITH WAKA KOTAHU NZ TRANSPORT AGENCY STANDARD MANUALS:
 - a) MANUAL OF TRAFFIC SIGNS AND MARKINGS, PART 2 MARKINGS
 - b) TRAFFIC CONTROL DEVICES MANUAL.
7. RAISED PAVEMENT MARKERS ARE TO BE REMOVED IN LOCATIONS WHERE LINE MARKINGS ARE SHOWN AS TO BE REMOVED.
8. BLUE RAISED PAVEMENT MARKERS INDICATING THE LOCATION OF FIRE HYDRANTS ARE TO BE RETAINED.

300 mm
200
100
50
0 10 mm

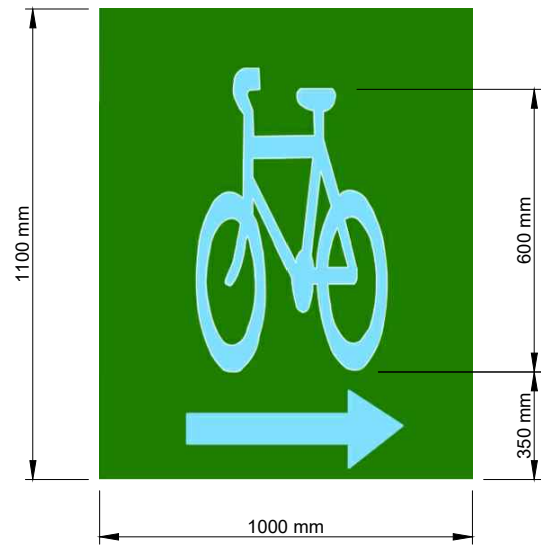

TYPICAL 'CYCLIST' PAINT MARKING
SCALE: NTS

1:125 @ A1
1:250 @ A3

REVISION	AMENDMENT	APPROVED	DATE
1	ISSUED FOR CONSTRUCTION	CG	2022-04-13
2	AMENDED CONSTRUCTION ISSUE	CG	2022-04-22



CIVIL - URBAN DESIGN

SCALES		ORIGINAL SIZE
1:125 (A1), 1:250 (A3)		A1
DRAWN	DESIGNED	APPROVED
P. MANI	U. GABRIEL	C. GROOM
DRAWING VERIFIED	DESIGN VERIFIED	APPROVED DATE
B. CRAIG	S. THORNTON	2022-04-13

FOR CONSTRUCTION

PROJECT		SHEET NO.	REVISION
WELLINGTON CITY COUNCIL NEWTOWN TO WATERFRONT CYCLEWAY		C218	2
TITLE		ADELAIDE ROAD - RIDDIFORD STREET TO BASIN RESERVE LANE MARKING PLAN - SHEET 5 OF 5	
WSP PROJECT NO. (SUB-PROJECT)		5-C4623.00(1)	

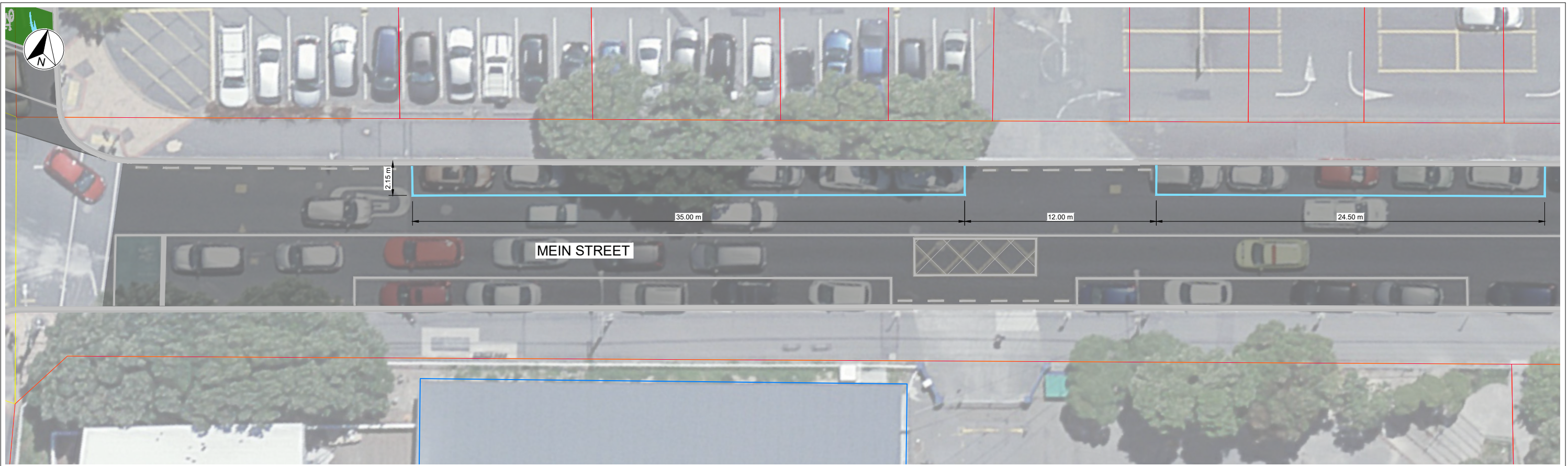

300 mm
200
100
50
0 10 mm

MEIN STREET

MEIN STREET

NOTES:

1. THE CONTRACTOR SHALL PRODUCE A DETAILED TRAFFIC MANAGEMENT PLAN THAT COVERS ALL ASPECTS OF CONTROLLING TRAFFIC THROUGHOUT THE DURATION OF THE WORKS.
2. WORKMANSHIP AND MATERIALS GENERALLY SHALL BE IN ACCORDANCE WITH THE RELEVANT NEW ZEALAND STANDARDS, THE N.Z. BUILDING CODE AND MANUFACTURERS WRITTEN RECOMMENDATIONS EXCEPT WHERE VARIED BY THE CONTRACT DOCUMENTS.
3. NOT ALL EXISTING SERVICES AND UTILITIES ARE SHOWN.
4. EXISTING SERVICES, THEIR LOCATIONS AND SIZES SHOWN ON THESE DRAWINGS ARE INDICATIVE ONLY AND ARE BASED ON RECORDS SUPPLIED BY THE UTILITY COMPANIES. PRIVATE SERVICES AND CONNECTIONS ARE NOT SHOWN.
5. THIS 2D DESIGN IS INDICATIVE ONLY AND HAS BEEN DRAWN WITHOUT THE USE OF A TOPOGRAPHIC SURVEY.
6. ALL PAVEMENT MARKINGS ARE TO BE IN ACCORDANCE WITH WAKA KOTAHĪ NZ TRANSPORT AGENCY STANDARD MANUALS:
 - a) MANUAL OF TRAFFIC SIGNS AND MARKINGS, PART 2 MARKINGS
 - b) TRAFFIC CONTROL DEVICES MANUAL.
7. RAISED PAVEMENT MARKERS ARE TO BE REMOVED IN LOCATIONS WHERE LINE MARKINGS ARE SHOWN AS TO BE REMOVED.
8. BLUE RAISED PAVEMENT MARKERS INDICATING THE LOCATION OF FIRE HYDRANTS ARE TO BE RETAINED.

LEGEND	
	EXISTING PAVEMENT MARKINGS TO REMAIN
	EXISTING PAVEMENT MARKINGS REMOVED
	NEW PAVEMENT MARKINGS
	CYCLE DIVIDER
	HIT POSTS - WHITE
	HIT POST - BLACK
	SPEED HUMP
	CYCLEWAY MARKING
	SHARROW MARKING

1:125 @ A1
1:250 @ A3

REVISION	AMENDMENT	APPROVED	DATE
1	ISSUED FOR CONSTRUCTION	CG	2022-04-22



CIVIL - URBAN DESIGN

SCALES		ORIGINAL SIZE
1:125 (A1), 1:250 (A3)		A1
DRAWN	DESIGNED	APPROVED
W. EATON	W. EATON	C. GROOM
DRAWING VERIFIED	DESIGN VERIFIED	APPROVED DATE
C. GROOM	C. GROOM	2022-04-22

FOR CONSTRUCTION

PROJECT	
WELLINGTON CITY COUNCIL NEWTOWN TO WATERFRONT CYCLEWAY	
TITLE	
MEIN STREET LANE MARKING PLAN	
WSP PROJECT NO. (SUB-PROJECT)	SHEET NO.
5-C4623.00(1)	C221
	REVISION
	1

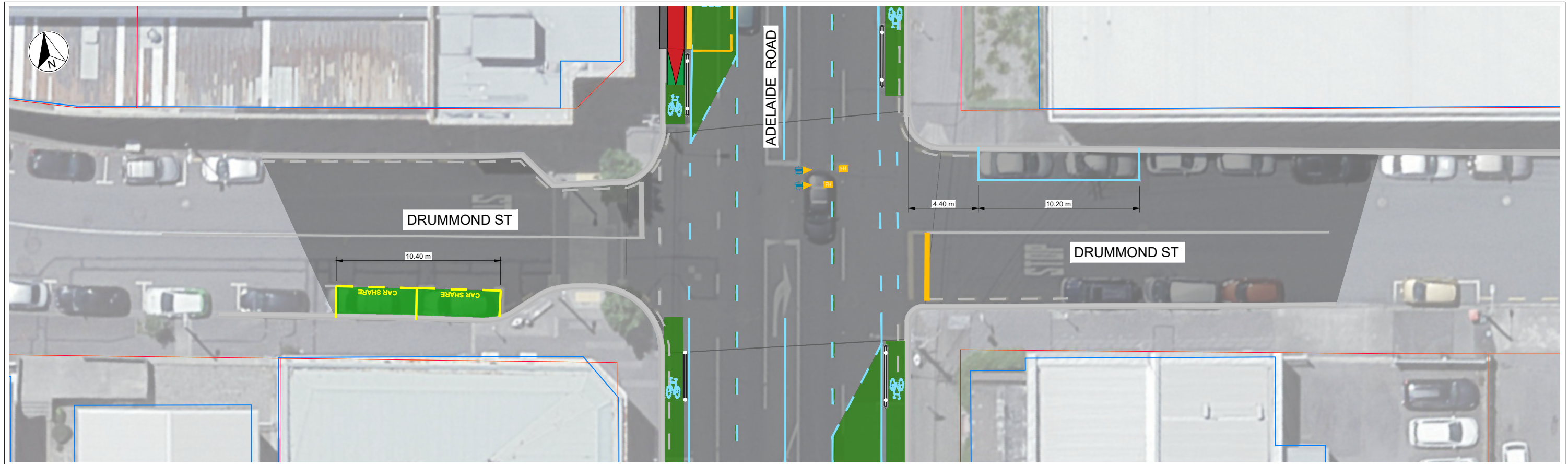

DRUMMOND STREET

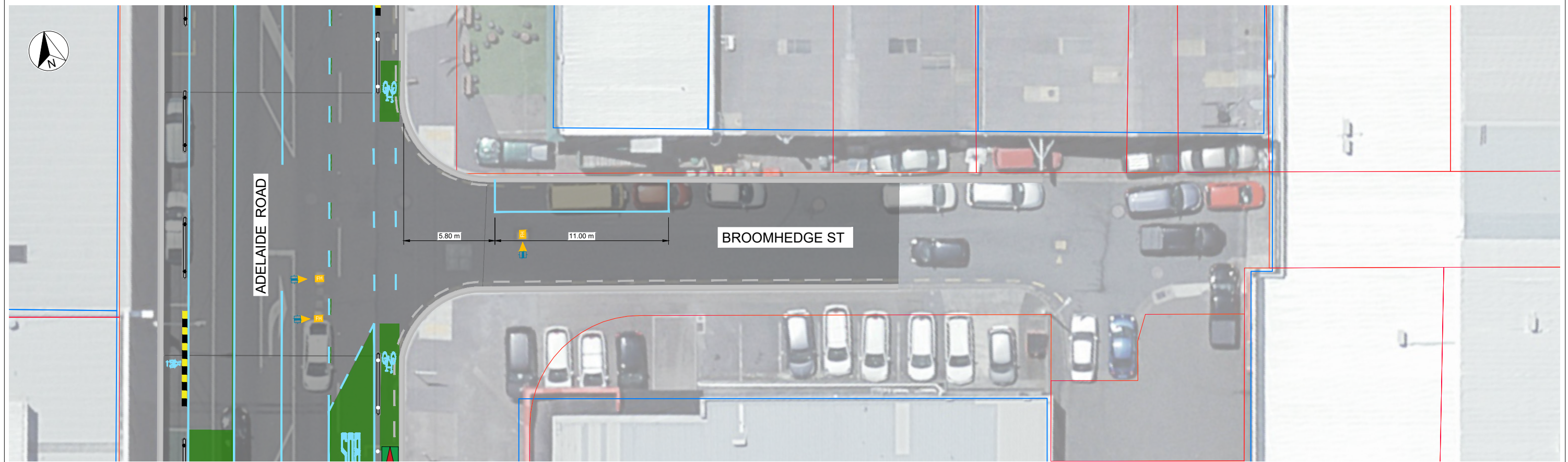

BROOMHEDGE STREET

1:125 @ A1
1:250 @ A3

REVISION	AMENDMENT	APPROVED	DATE
1	ISSUED FOR CONSTRUCTION	CG	2022-04-22



Wellington Office
+64 4 471 7000

PO Box 12-003
Wellington 6144
New Zealand

CIVIL - URBAN DESIGN

SCALES		ORIGINAL SIZE
1:125 (A1), 1:250 (A3)		A1
DRAWN	DESIGNED	APPROVED
W. EATON	W. EATON	C. GROOM
DRAWING VERIFIED	DESIGN VERIFIED	APPROVED DATE
C. GROOM	C. GROOM	2022-04-22

FOR CONSTRUCTION

PROJECT		SHEET NO.		REVISION	
WELLINGTON CITY COUNCIL NEWTOWN TO WATERFRONT CYCLEWAY		C222		1	
TITLE					
DRUMMOND STREET AND BROOMHEDGE STREET LANE MARKING PLANS					
WSP PROJECT NO. (SUB-PROJECT)				SHEET NO.	
5-C4623.00(1)				C222	



300 mm
200
100
50
0 10 mm

DOUGLAS STREET

1:125@ A1
1:250@ A3

REVISION	AMENDMENT	APPROVED	DATE
1	ISSUED FOR CONSTRUCTION	CG	2022-04-22



wsp
Wellington Office
+64 4 471 7000
PO Box 12-003
Wellington 6144
New Zealand

CIVIL - URBAN DESIGN

SCALES		ORIGINAL SIZE
1:125 (A1), 1:250 (A3)		A1
DRAWN	DESIGNED	APPROVED
W. EATON	W. EATON	C. GROOM
DRAWING VERIFIED	DESIGN VERIFIED	APPROVED DATE
C. GROOM	C. GROOM	2022-04-22

FOR CONSTRUCTION

PROJECT		SHEET NO.	REVISION
WELLINGTON CITY COUNCIL NEWTOWN TO WATERFRONT CYCLEWAY		C223	1
TITLE			
DOUGLAS STREET LANE MARKING PLAN			
WSP PROJECT NO. (SUB-PROJECT)			
5-C4623.00(1)			



PLACEMAKING LEGEND

- NEW SEATING UNITS
- NEW PLANTING BOXES WITH SHRUBS
- NEW TREE PLANTER BOXES

LEGEND

- EXISTING PAVEMENT MARKINGS TO REMAIN
- EXISTING PAVEMENT MARKINGS REMOVED
- NEW PAVEMENT MARKINGS
- CYCLE DIVIDER
- HIT POSTS - WHITE
- HIT POSTS - BLACK
- SPEED HUMP
- CYCLEWAY MARKING
- SHARROW MARKING
- PAINTED PAVEMENT AREAS FOR 'BUS ONLY' LANES AND CYCLEWAY
- SHARED PATH SYMBOL

1:125 @ A1
1:250 @ A3

REVISION	AMENDMENT	APPROVED	DATE
1	FOR CONSTRUCTION	C.G.	2022-06-22
2	UPDATE BASED ON CLIENT FEEDBACK	C.G.	2022-08-09



CAMBRIDGE TERRACE - PART 1

CIVIL - URBAN DESIGN

SCALES	DESIGNED BY	APPROVED	ORIGINAL SIZE
1:125 (A1), 1:250 (A3)	U. GABRIEL	C. GROOM	A1
DRAWN	DESIGN VERIFIED	APPROVED DATE	
W.EATON	R. BATTY	2022-06-22	

FOR CONSTRUCTION

PROJECT	TITLE	WSP PROJECT NO. (SUB-PROJECT)	SHEET NO.	REVISION
WELLINGTON CITY COUNCIL NEWTOWN TO WATERFRONT CYCLEWAY	CAMBRIDGE TERRACE - BASIN RESERVE TO ORIENTAL PARADE LANE MARKING PLAN - SHEET 1 OF 9	5-C4623.00(1)	C311	2



CAMBRIDGE TERRACE - PART 2

1:125 @ A1
1:250 @ A3

REVISION	AMENDMENT	APPROVED	DATE
1	FOR CONSTRUCTION	C.G.	2022-06-22
2	UPDATE BASED ON CLIENT FEEDBACK	C.G.	2022-08-09



CIVIL - URBAN DESIGN

SCALES	DESIGNED	APPROVED	ORIGINAL SIZE
1:125 (A1), 1:250 (A3)	U. GABRIEL	C. GROOM	A1
DRAWN	DESIGNED	APPROVED	
W.EATON	U. GABRIEL	C. GROOM	
DRAWING VERIFIED	DESIGN VERIFIED	APPROVED DATE	
C. GROOM	R. BATTY	2022-06-22	

FOR CONSTRUCTION

PROJECT	TITLE	WSP PROJECT NO. (SUB-PROJECT)	SHEET NO.	REVISION
WELLINGTON CITY COUNCIL NEWTOWN TO WATERFRONT CYCLEWAY	CAMBRIDGE TERRACE - BASIN RESERVE TO ORIENTAL PARADE LANE MARKING PLAN - SHEET 2 OF 9	5-C4623.00(1)	C312	2



1:125 @ A1
1:250 @ A3

CAMBRIDGE TERRACE - PART 3

REVISION	AMENDMENT	APPROVED	DATE
1	FOR CONSTRUCTION	C. G.	2022-06-22



CIVIL - URBAN DESIGN

SCALES		ORIGINAL SIZE
1:125 (A1), 1:250 (A3)		A1
DRAWN	DESIGNED	APPROVED
W. EATON	U. GABRIEL	C. GROOM
DRAWING VERIFIED	DESIGN VERIFIED	APPROVED DATE
C. GROOM	R. BATTY	2022-06-22

FOR CONSTRUCTION

PROJECT		SHEET NO.	REVISION
WELLINGTON CITY COUNCIL NEWTOWN TO WATERFRONT CYCLEWAY		C313	1
TITLE		CAMBRIDGE TERRACE - BASIN RESERVE TO ORIENTAL PARADE LANE MARKING PLAN - SHEET 3 OF 9	
WSP PROJECT NO. (SUB-PROJECT)		5-C4623.00(1)	

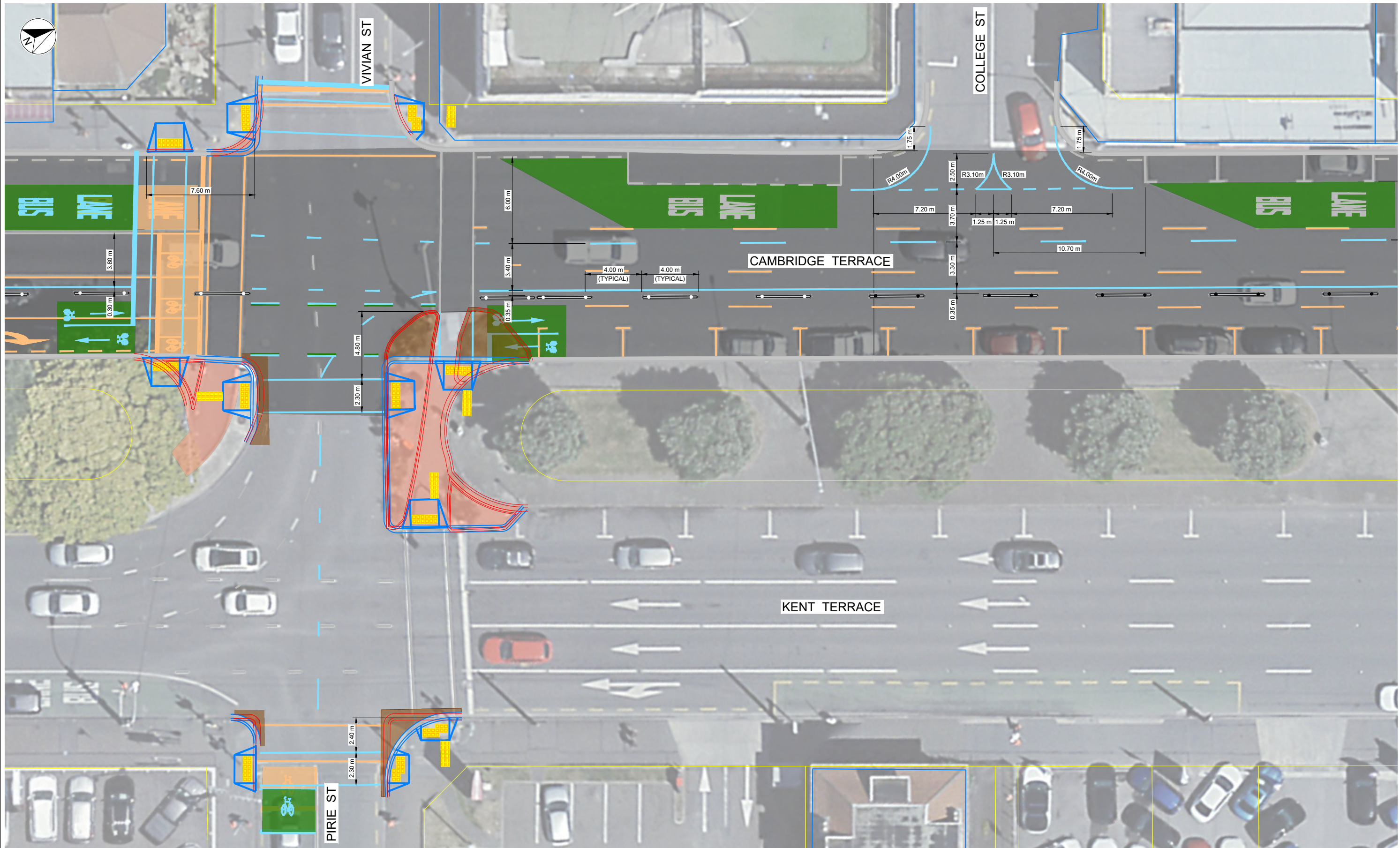

CAMBRIDGE TERRACE - PART 4

1:125 @ A1
1:250 @ A3

REVISION	AMENDMENT	APPROVED	DATE
1	FOR CONSTRUCTION	C.G.	2022-06-22



CIVIL - URBAN DESIGN

SCALES		ORIGINAL SIZE
1:125 (A1), 1:250 (A3)		A1
DRAWN	DESIGNED	APPROVED
W.EATON	U. GABRIEL	C. GROOM
DRAWING VERIFIED	DESIGN VERIFIED	APPROVED DATE
C. GROOM	R. BATTY	2022-03-16

FOR CONSTRUCTION

PROJECT		SHEET NO.	REVISION
WELLINGTON CITY COUNCIL NEWTOWN TO WATERFRONT CYCLEWAY		C314	1
TITLE		CAMBRIDGE TERRACE - BASIN RESERVE TO ORIENTAL PARADE LANE MARKING PLAN - SHEET 4 OF 9	
WSP PROJECT NO. (SUB-PROJECT)		5-C4623.00(1)	



CAMBRIDGE TERRACE - PART 5

1:125 @ A1
1:250 @ A3

REVISION	AMENDMENT	APPROVED	DATE
1	FOR CONSTRUCTION	C.G.	2022-06-22



CIVIL - URBAN DESIGN

SCALES		ORIGINAL SIZE
1:125 (A1), 1:250 (A3)		A1
DRAWN	DESIGNED	APPROVED
W.EATON	C. GROOM	C. GROOM
DRAWING VERIFIED	DESIGN VERIFIED	APPROVED DATE
U. GABRIEL	R. BATTY	2022-06-22

FOR CONSTRUCTION

PROJECT		SHEET NO.	REVISION
WELLINGTON CITY COUNCIL NEWTOWN TO WATERFRONT CYCLEWAY		C315	1
TITLE			
CAMBRIDGE TERRACE - BASIN RESERVE TO ORIENTAL PARADE LANE MARKING PLAN - SHEET 5 OF 9			
WSP PROJECT NO. (SUB-PROJECT)			
5-C4623.00(1)			

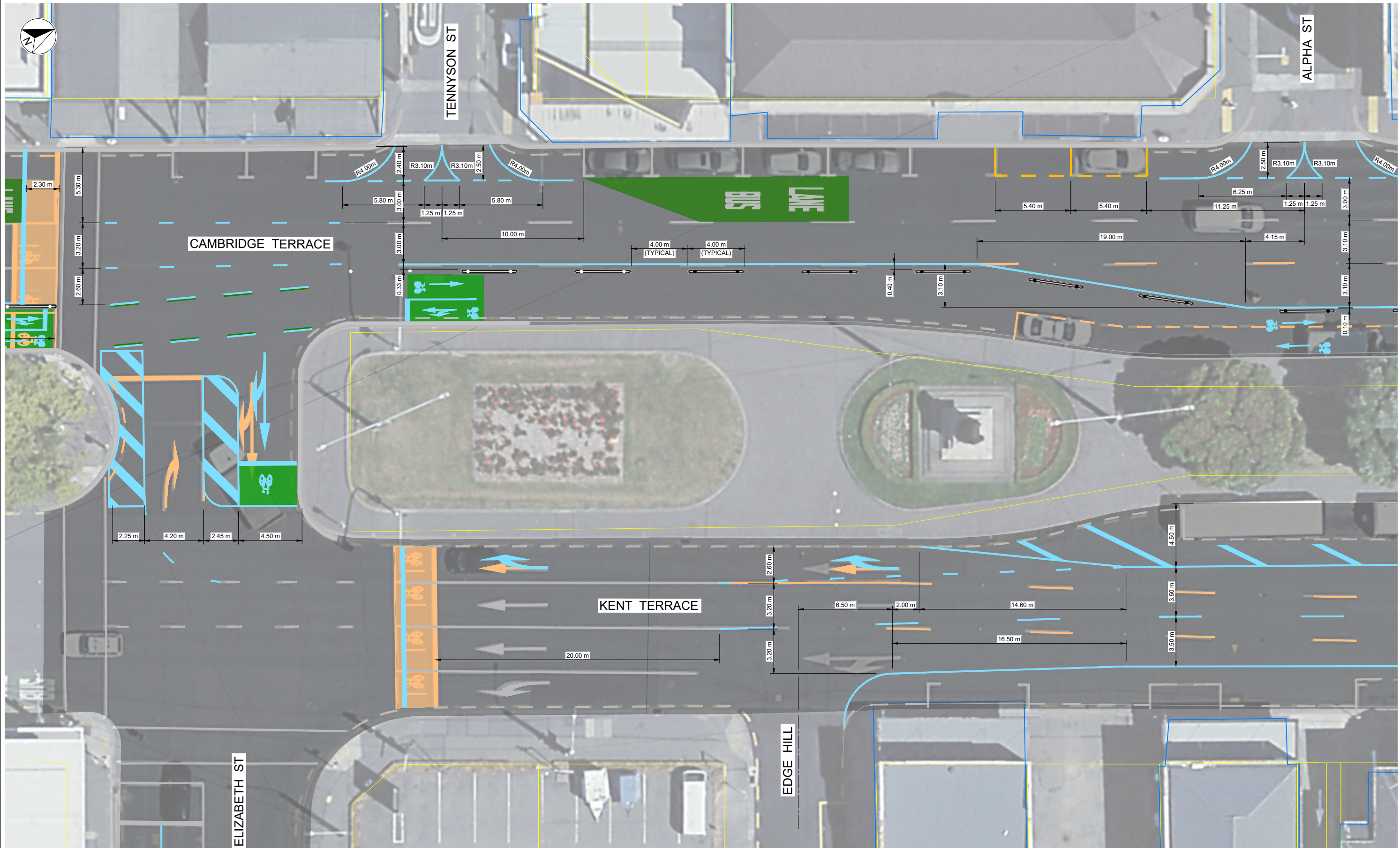

300 mm
200
100
50
0 10 mm

1:125 @ A1
1:250 @ A3

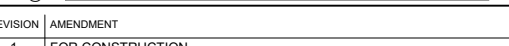

CAMBRIDGE TERRACE - PART 6

REVISION	AMENDMENT	APPROVED	DATE
1	FOR CONSTRUCTION	C.G.	2022-06-22



CIVIL - URBAN DESIGN

SCALES		ORIGINAL SIZE
1:125 (A1), 1:250 (A3)		A1
DRAWN	DESIGNED	APPROVED
W.EATON	U. GABRIEL	C. GROOM
DRAWING VERIFIED	DESIGN VERIFIED	APPROVED DATE
C. GROOM	R. BATTY	2022-06-22

FOR CONSTRUCTION

PROJECT		SHEET NO.	REVISION
WELLINGTON CITY COUNCIL NEWTOWN TO WATERFRONT CYCLEWAY		C316	1
TITLE			
CAMBRIDGE TERRACE - BASIN RESERVE TO ORIENTAL PARADE LANE MARKING PLAN - SHEET 6 OF 9			
WSP PROJECT NO. (SUB-PROJECT)			
5-C4623.00(1)			

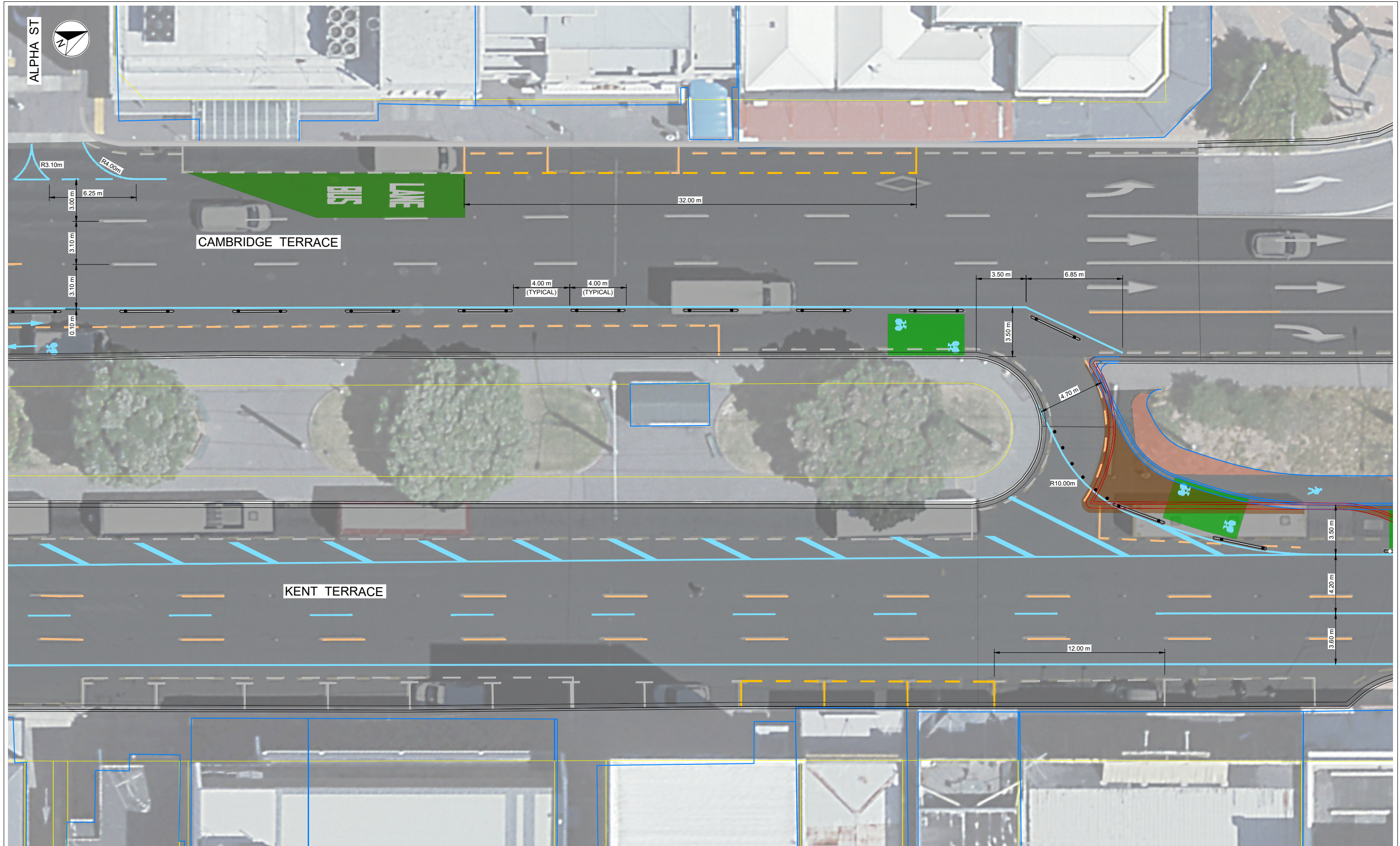

300 mm
200
100
50
0 10 mm

ALPHA ST

CAMBRIDGE TERRACE

KENT TERRACE

CAMBRIDGE TERRACE - PART 7

1:125 @ A1
1:250 @ A3

REVISION	AMENDMENT	APPROVED	DATE
1	FOR CONSTRUCTION	C. G.	2022-06-22



CIVIL - URBAN DESIGN

SCALES		ORIGINAL SIZE
1:125 (A1), 1:250 (A3)		A1
DRAWN	DESIGNED	APPROVED
W. EATON	U. GABRIEL	C. GROOM
DRAWING VERIFIED	DESIGN VERIFIED	APPROVED DATE
C. GROOM	R. BATTY	2022-06-22

FOR CONSTRUCTION

PROJECT		SHEET NO.		REVISION	
WELLINGTON CITY COUNCIL NEWTOWN TO WATERFRONT CYCLEWAY		C317		1	
TITLE					
CAMBRIDGE TERRACE - BASIN RESERVE TO ORIENTAL PARADE LANE MARKING PLAN - SHEET 7 OF 9					
WSP PROJECT NO. (SUB-PROJECT)				SHEET NO.	
5-C4623.00(1)				C317	

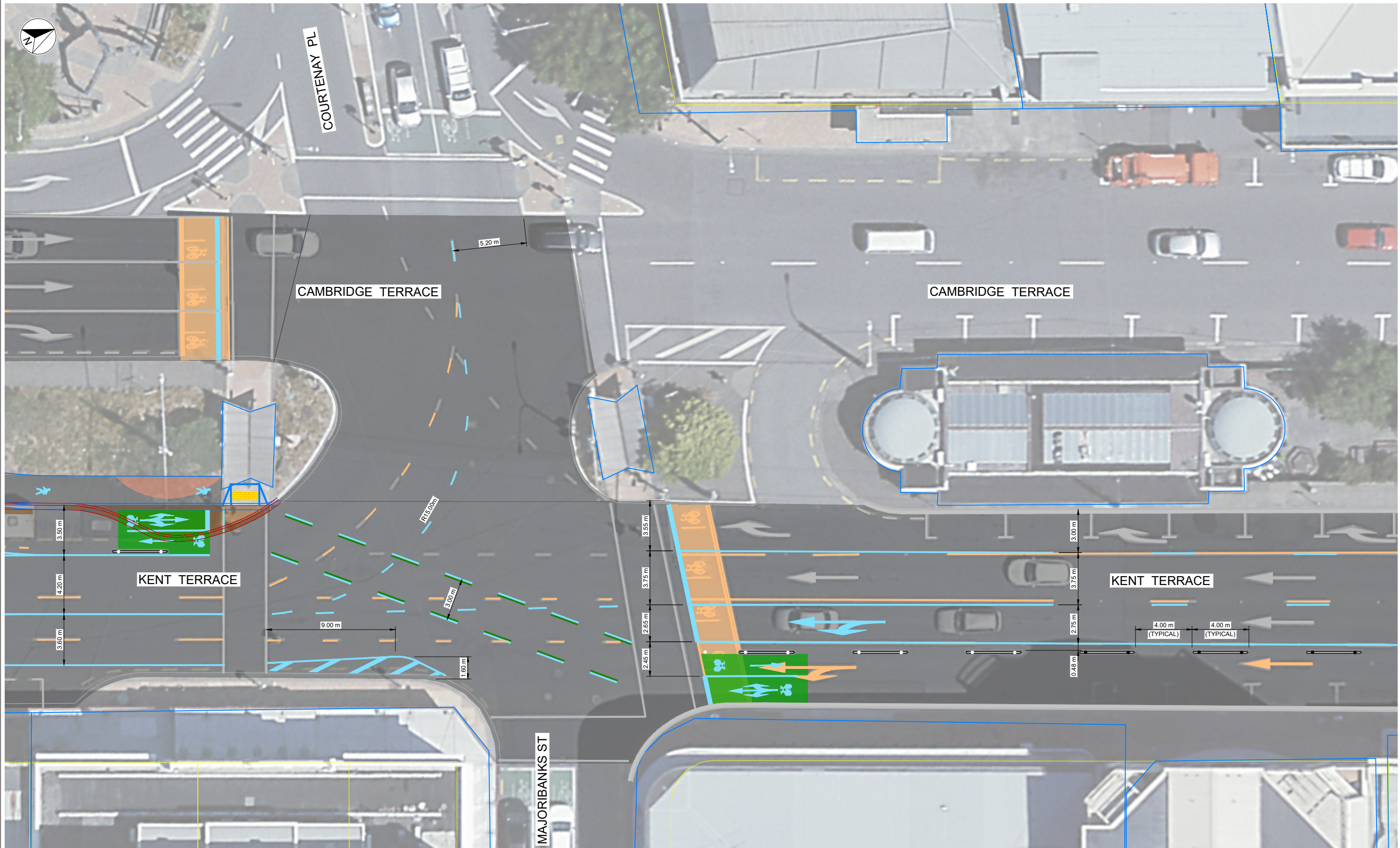

300 mm
200
100
50
0 10 mm

1:125 @ A1
1:250 @ A3

CAMBRIDGE TERRACE - PART 8

REVISION	AMENDMENT	APPROVED	DATE
1	FOR CONSTRUCTION	C. G.	2022-06-22



CIVIL - URBAN DESIGN

SCALES	DESIGNED	APPROVED
1:125 (A1), 1:250 (A3)	U. GABRIEL	C. GROOM
DRAWN	DESIGN VERIFIED	APPROVED DATE
W. EATON	R. BATTY	2022-06-22

FOR CONSTRUCTION

PROJECT	TITLE	WSP PROJECT NO. (SUB-PROJECT)	SHEET NO.	REVISION
WELLINGTON CITY COUNCIL NEWTOWN TO WATERFRONT CYCLEWAY	CAMBRIDGE TERRACE - BASIN RESERVE TO ORIENTAL PARADE LANE MARKING PLAN - SHEET 8 OF 9	5-C4623.00(1)	C318	1

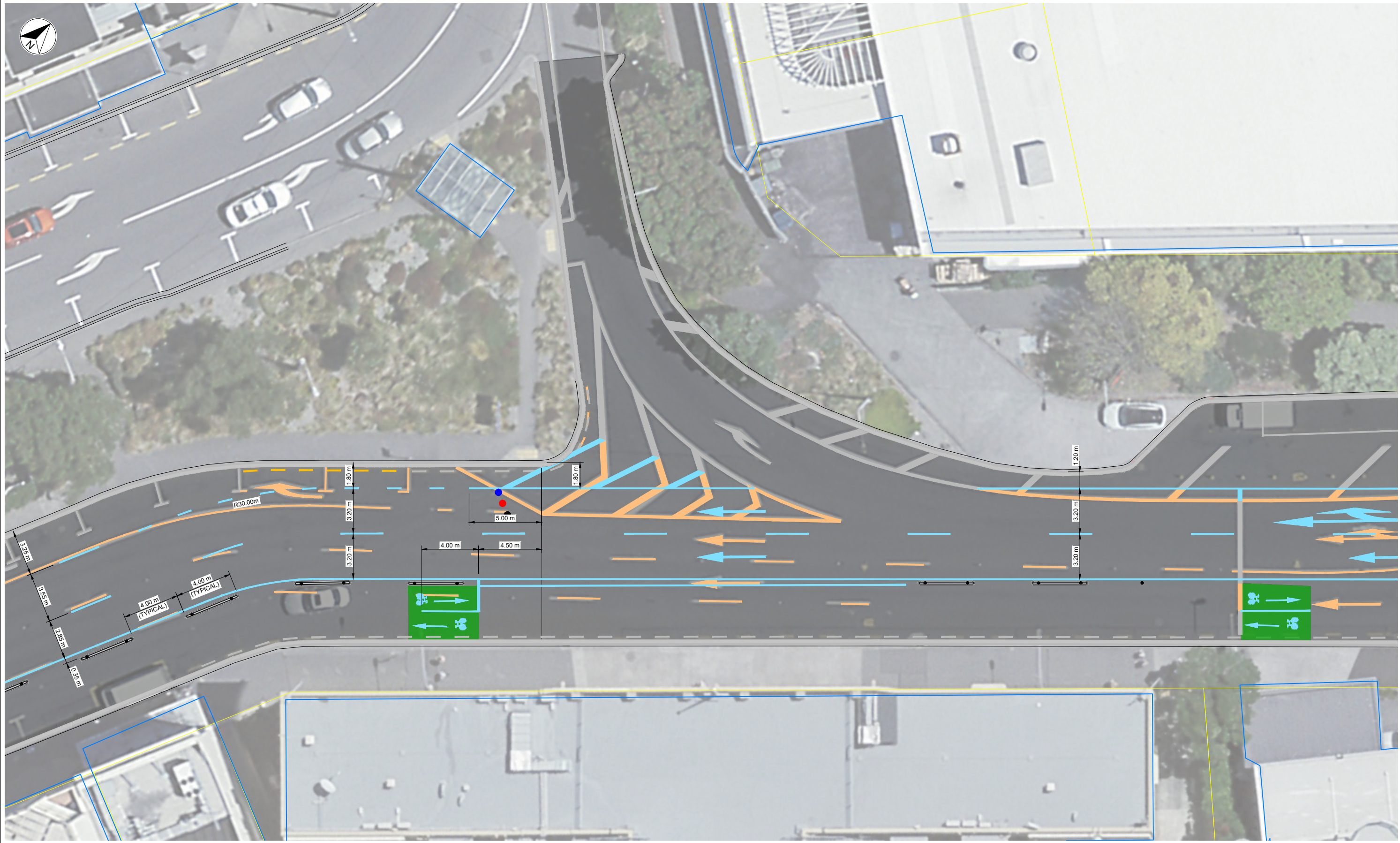

ORIENTAL PARADE - PART 1

1:125 @ A1
1:250 @ A3

REVISION	AMENDMENT	APPROVED	DATE
1	ISSUED FOR CONSTRUCTION	C. G.	2022-03-21



CIVIL - URBAN DESIGN

SCALES	DESIGNED	APPROVED	ORIGINAL SIZE
1:125 (A1), 1:250 (A3)	U. GABRIEL	C. GROOM	A1
DRAWN	DESIGNED	APPROVED	
W. EATON	U. GABRIEL	C. GROOM	
DRAWING VERIFIED	DESIGN VERIFIED	APPROVED DATE	
C. GROOM	R. BATTY	2022-03-21	

FOR CONSTRUCTION

PROJECT	TITLE	WSP PROJECT NO. (SUB-PROJECT)	SHEET NO.	REVISION
WELLINGTON CITY COUNCIL NEWTOWN TO WATERFRONT CYCLEWAY	KENT TERRACE / ORIENTAL PARADE TO CABLE STREET LANE MARKING PLAN - SHEET 1 OF 2	5-C4623.00(1)	C321	1

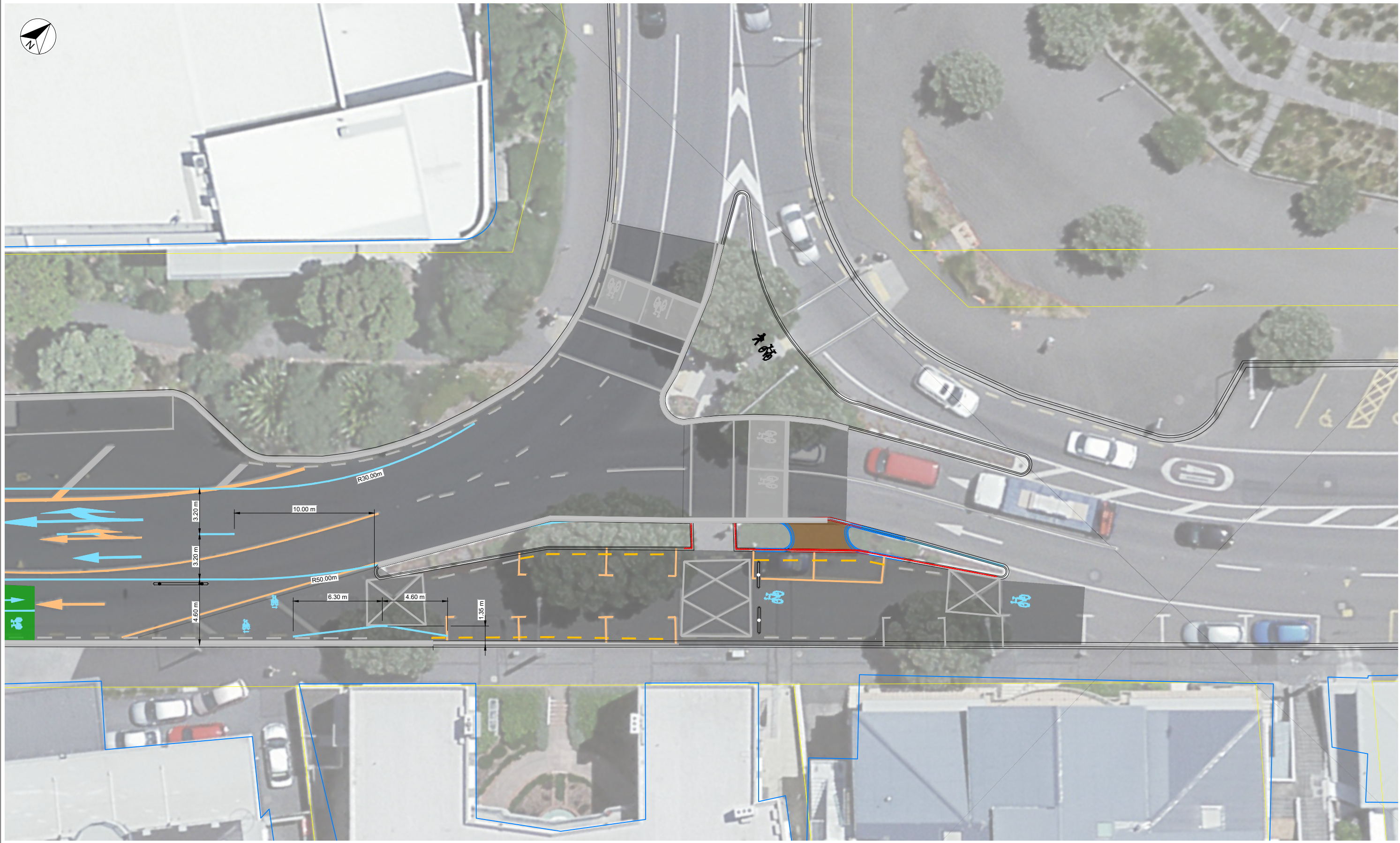

ORIENTAL PARADE - PART 2

1:125 @ A1
1:250 @ A3

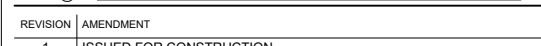

REVISION	AMENDMENT	APPROVED	DATE
1	ISSUED FOR CONSTRUCTION	C. G.	2022-03-21



CIVIL - URBAN DESIGN

SCALES		ORIGINAL SIZE
1:125 (A1), 1:250 (A3)		A1
DRAWN	DESIGNED	APPROVED
W. EATON	U. GABRIEL	C. GROOM
DRAWING VERIFIED	DESIGN VERIFIED	APPROVED DATE
C. GROOM	R. BATTY	2022-03-21

FOR CONSTRUCTION

PROJECT		ORIGINAL SIZE
WELLINGTON CITY COUNCIL NEWTOWN TO WATERFRONT CYCLEWAY		A1
TITLE		
KENT TERRACE / ORIENTAL PARADE TO CABLE STREET LANE MARKING PLAN - SHEET 2 OF 2		
WSP PROJECT NO. (SUB-PROJECT)	SHEET NO.	REVISION
5-C4623.00(1)	C322	1



ROXBURGH STREET

1:125@ A1
1:250@ A3

REVISION	AMENDMENT	APPROVED	DATE
1	ISSUED FOR CONSTRUCTION	C.G.	2022-08-09



CIVIL - URBAN DESIGN

SCALES		ORIGINAL SIZE
1:125 (A1), 1:250 (A3)		A1
DRAWN	DESIGNED	APPROVED
W. EATON	C. GROOM	C. GROOM
DRAWING VERIFIED	DESIGN VERIFIED	APPROVED DATE
C. GROOM	C. GROOM	2022-08-09

FOR CONSTRUCTION

PROJECT	TITLE	SHEET NO.	REVISION
WELLINGTON CITY COUNCIL NEWTOWN TO WATERFRONT CYCLEWAY	ROXBURGH STREET LANE MARKING PLAN - SHEET 1 OF 1	C325	1
WSP PROJECT NO. (SUB-PROJECT)			
5-C4623.00(1)			